

# HOW TO PREPARE YOUR ARTWORK FOR HANGING IN THE ANGLESEA ART SPACE!

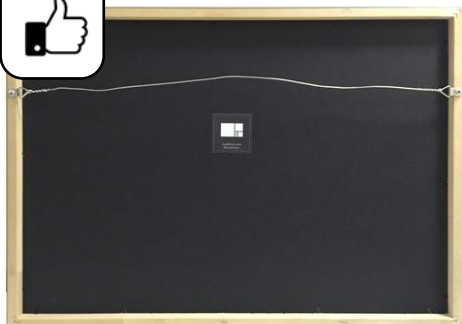

## These options are OK



Something like the above is ideal and is expected at most galleries. You can buy the 'D-rings' and wire from a hardware store. Make sure you position the wire about a 1/4-1/3 from the top. Any lower and the frame begins to tilt too much on the wall.

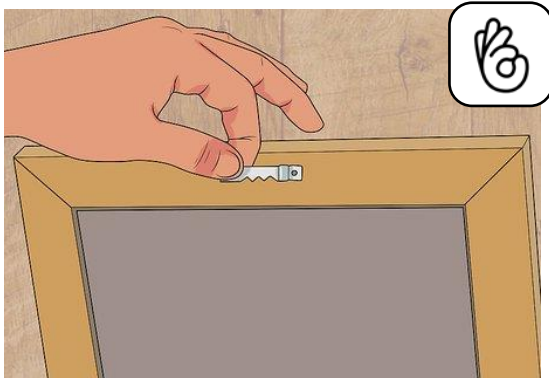

This option is not great, but it will do for this exhibition if you can't organise anything else. Make sure you don't position it too close to the top, because then the hook we use will show.

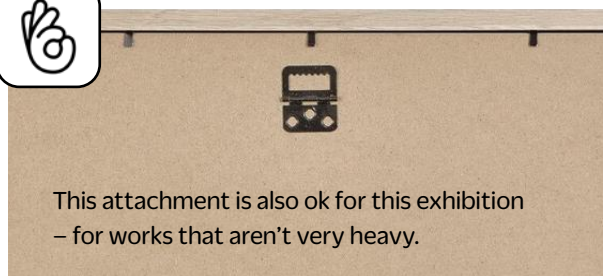

This attachment is also ok for this exhibition – for works that aren't very heavy.

## These options are NOT OK

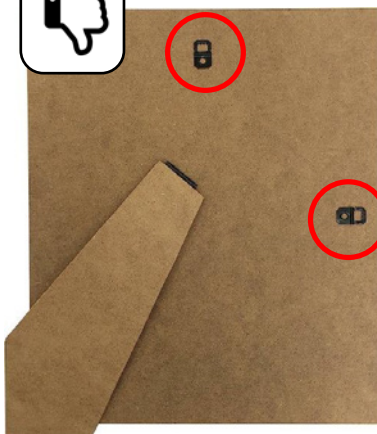
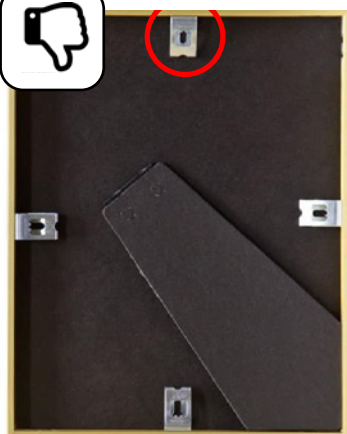

Most small premade frames have these metal attachments.

They are not suitable because they bend too much, and often pull out completely. If you have a frame like this, you can go to a hardware shop and buy 'D-rings', or self tapping screws to attach to each side of the frame - then attach a hanging wire (see images in the 'OK' section!)

None of the above options can be hung successfully. Please see the 'OK' section for alternatives. If you arrive with works that cannot be hung, unfortunately you will not be included in the exhibition. Small works may be able to stand on plinths, but we prefer you try to prepare them properly

